

CITY OF WABASH ZONING JURISDICTION, 2011

WABASH, INDIANA

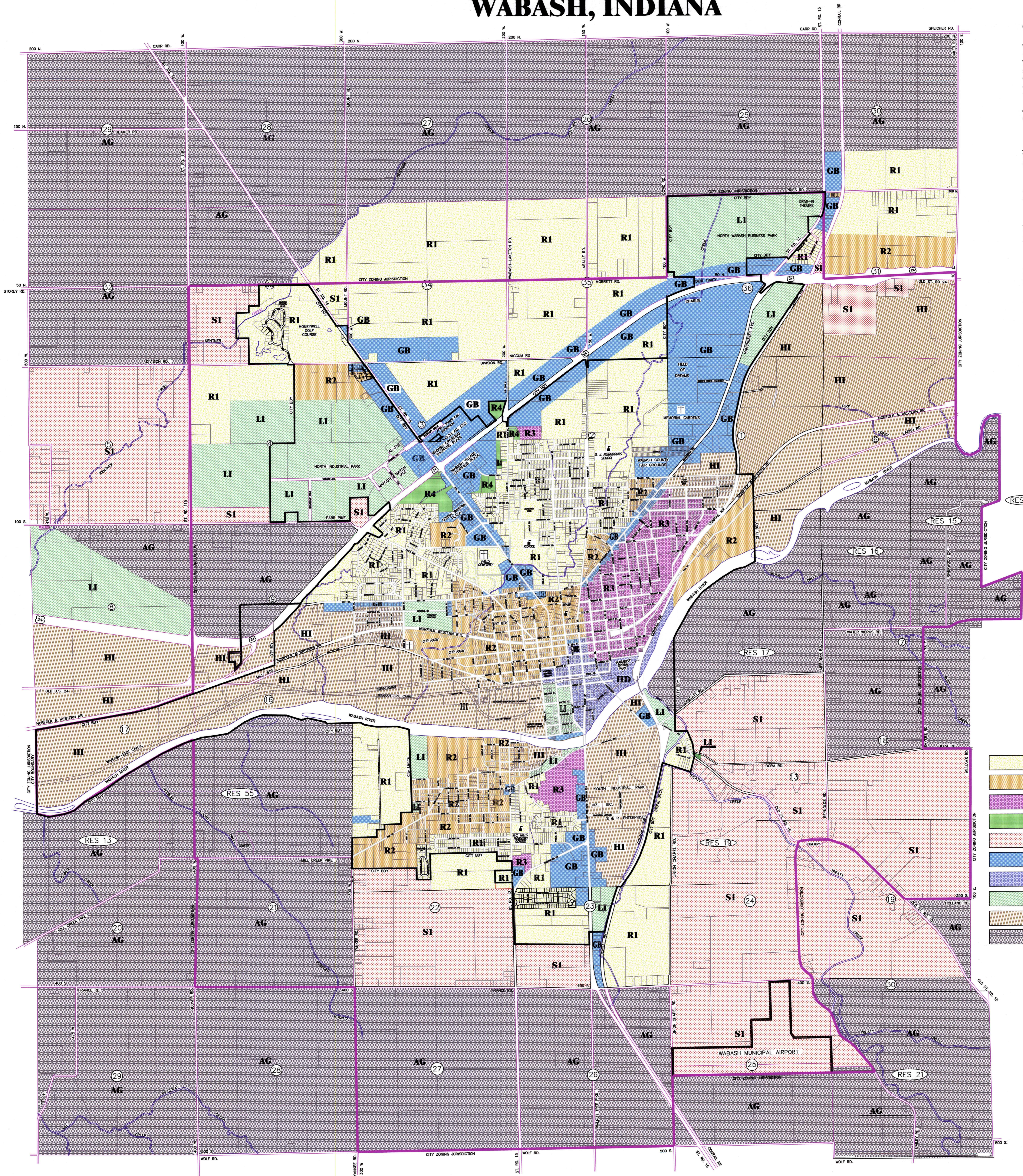

CERTIFICATION:

We, the undersigned, hereby certify that the foregoing Zone Map for the City of Wabash was duly approved on the dates set forth below by the Wabash Plan Commission and the Common Council of the City of Wabash all in accordance with the laws of the State of Indiana.

Approved by the Wabash Plan Commission the 7th day of December, 2011.

Karl Rider
Wabash City Plan Commission by
Karl Rider (president)

Approved by the Common Council of the City of Wabash the 12th day of December, 2011.

Scott A. Long
Common Council of the City of Wabash by
Scott Long (president)

Robert E. Vanlandingham
City of Wabash by
Robert E. Vanlandingham, (mayor)

Ron Bussard
Ron Bussard
Building Commissioner

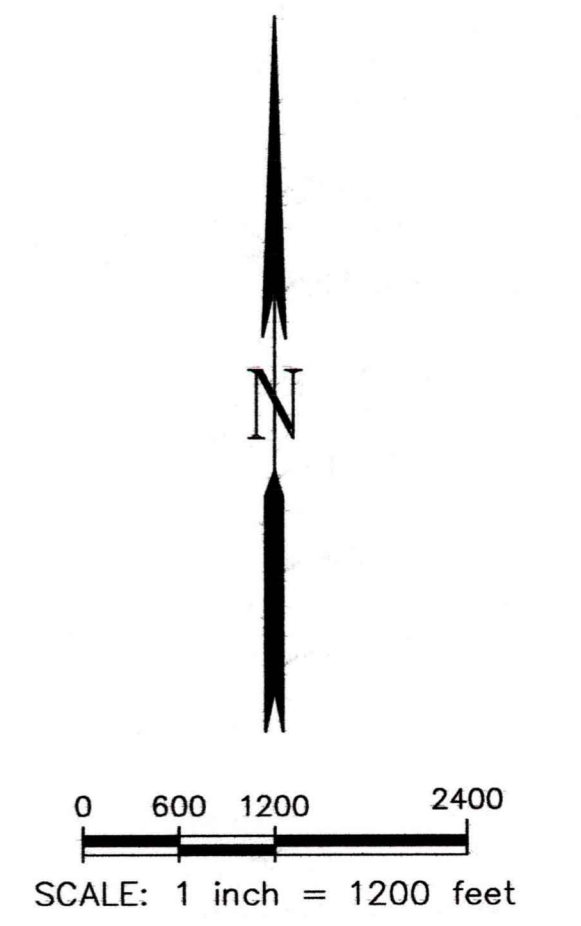

- WABASH CORPORATION
- ZONING JURISDICTION
- SECTION NUMBER
- RESERVE NUMBER

LEGEND

- R1 RESIDENTIAL 1
- R2 RESIDENTIAL 2
- R3 RESIDENTIAL 3
- R4 RESIDENTIAL 4
- S1 SUBURBAN 1
- GB GENERAL BUSINESS
- HD HISTORICAL DOWNTOWN
- LI LIGHT INDUSTRIAL
- HI HEAVY INDUSTRIAL
- AG AGRICULTURAL

RANDALL MILLER & ASSOCIATES INC.
Surveyors • Engineers • Consultants
<http://www.rmasurveying.com>

145 E. Third Street Marion, IN 46952
Ph: (765) 662-1284 FAX: (765) 668-7412
Email: marion@rmasurveying.com

108 E. Washington St., Ste #5 Muncie, IN 47305
Ph: (765) 289-1917 Fax: (765) 289-1931
Email: muncie@rmasurveying.com

58 W. Market Street, Ste. J Wabash, IN 46992
Ph: (260) 563-4467 Fax: (260) 563-0462
Email: wabash@rmasurveying.com

300 E. Broadway, Ste. 106 Logansport, IN 46947
Ph: (574) 753-9353 Fax: (574) 753-9485
Email: logansport@rmasurveying.com